

T850 / T851

INSTALLATION INSTRUCTIONS

TRP BRAKES

688 W. Amidan Dr. 4X-1
 Ogden, UT 84404
 Toll Free: 1-877-807-4162
 Direct: 1-650-965-4442

Email: info@trpbrakes.com
 Web: www.trpbrakes.com

SAFETY WARNINGS

- Improper use of your bicycle's brake system may result in loss of control or an accident which could lead to severe injury. Because each bicycle may handle differently, be sure to learn the proper braking technique (including brake lever force and bicycle control characteristics) for your bicycle. Consult your bicycle dealer and/or the bicycle owner's manual and practice your riding and braking technique.
- Securely tighten the caliper brake mounting hardware to the specified torque.
 When re-installing, apply blue thread retaining compound to the brake mounting bolts threads and tighten to specified torque using a calibrated torque wrench.
- If the mounting bolt(s) become loose, this could cause the brake to work improperly and cause an accident. This is a particular danger with the front wheel as the rider may be thrown forward resulting in serious injury.
- Brakes designed for use as rear brakes should not be used as front brakes and vice versa.
- Read the service instructions carefully prior to installing the brakes. Loose, worn or damaged parts may cause serious injury.
- Be careful not to allow any oil or grease to get onto the brake pads. If the pads become contaminated, they should be replaced and the braking surface of the rims cleaned carefully, otherwise the brakes may not work effectively.
- Always make sure the front and rear brakes are working correctly before you ride the bicycle.
- The required stopping distance will be longer in wet conditions. Tires will also skid more easily, which can result in loss of control. Reduce your speed by applying the brakes early and gently.
- If using standard Tektro brake pads in combination with ceramic-coated or carbon fiber rims, the pads will wear more quickly than normal. Pads specifically designed for carbon fiber rim surfaces are available from Tektro/TRP Brakes. Also consult your rim manufacturer for approved pads.
- Pads should be replaced if they have worn to the point that the grooves are no longer visible.
- Parts are not guaranteed against natural wear or deterioration resulting from normal use or crash damage.
- If you are unfamiliar with any element of assembly or maintenance of this brake system, consult a qualified mechanic or contact Tektro / TRP Brakes Customer Service.

TRP hydraulic disc brakes are **warranted** against manufacturing defects in materials and / or workmanship for a period of two years from the date of original retail purchase. Not covered under this warranty is damage resulting from improper installation, adjustment or maintenance, lack of maintenance, alterations, crashes or use judged by Tektro to be excessive or abusive. For warranty related questions or more information please contact a TRP Service Center or e-mail at info@trpcycling.com

EXPLODED VIEW OF BRAKE ASSEMBLY

T851 Side Pull

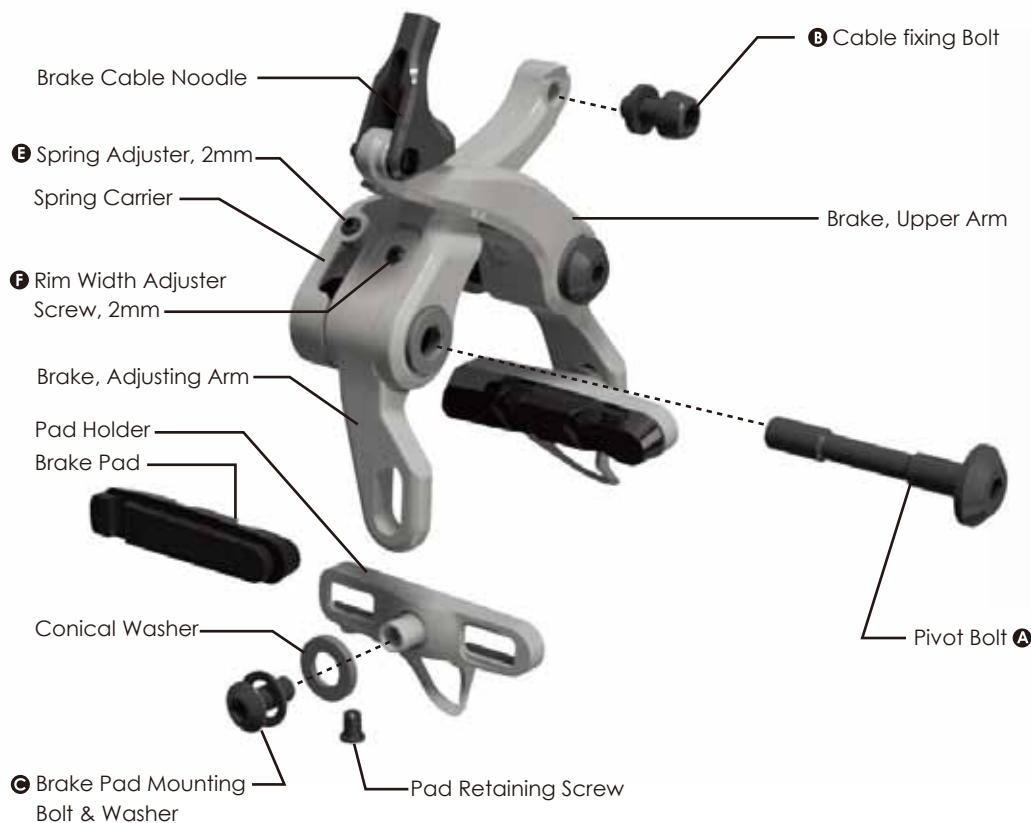

T850 Center Pull



Torque Specifications:

A Pivot bolt: 6-7 Nm (53-72 in-lb)

B Cable fixing bolt: 6 Nm (53 in-lb)

C Pad fixing bolt: 3-4 Nm (26-35 in-lb)

D T15 Cable fixing screw (T850 Center pull): 6 Nm (53in-lb)

INSTALLATION ON FRAME

Tools needed:
4mm hex wrench
Torque wrench

1. The T850/851 is designed for Direct Mount specific frames.
2. Install each pivot bolt **A** into its respective hold on the frame or fork. Engage a few threads of each bolt alternately, instead of threading one bolt all the way in.
3. Tighten the pivot bolts to 6-7 Nm (53-62 in-lbs) torque using a torque wrench.
3. Pull the upper arms together to make sure there is free movement with no friction.
4. If installed on the frame under the bottom bracket, spin the cranks, particularly to check clearance with crank mounted power meters.

4mm Hex wrench
Torque: 6-7 Nm(53-62 in-lbs)

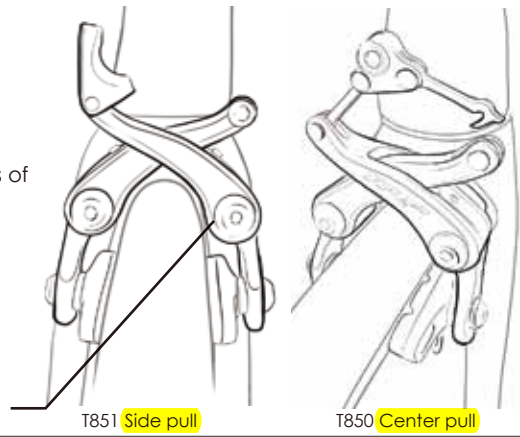

BRAKE SET-UP

Tools needed:
5mm hex wrench
2mm hex wrench
T15 Torx wrench
Torque wrench
Cable cutters
Compressionless housing cutters

Cable Installation

Compressionless (linear strand) brake housing, is recommended for T850/T851 Road brakes to yield the best performance. Sealing systems other than that supplied with your TRP brake are not recommended as they may create excess friction and affect the brake lever return performance. Route housing to minimize tight bends and acute angles.

A short length of spiral wound is best for use at the brake lever to **accommodate** the sharp bend at the handlebar.

Take particular care when measuring and cutting the brake cable for bottom bracket mounted rear brakes, such as with the T851. Housing that is too long will push on the brake arm and cause a soft or squishy feel.

B Cable fixing bolt torque for T851: 6 Nm (53 in-lb)

D Cable fixing screw torque for T850: 6 Nm (53 in-lb)

Prior to riding, bend the cable after the brake cable fixing bolt so that it does not contact the crank arm. **(B-2)**

A note about cable routing

TT and Aero road bikes often have cable routing that is more complex than traditional road bikes. Reduce tight bends and kinks as much as possible to reduce friction for your rear brake. Compressionless housing should be used to improve a soft or 'spongy' feeling brake.

Brake Pad Adjustment

Brake pads will need to be adjusted to fit your particular rim. **Including** a slight toe-in will reduce noise or vibration.

Use a 4mm hex wrench to reposition the brake pad holders **C**. Tighten to **approve** 3 Nm (26 in-lb) The brake arms can be adjusted to your rim width using the 2mm hex wrench. If this feature is used frequently, you may need to reapply blue thread retainer occasionally to the screw threads.

Spring Tension Adjustment

Once the pads have been set to your rims, the spring balance can be adjusted with the 2mm Spring Adjuster Screw **E**. Threading the set-screw in will increase spring tension. Threading out will reduce spring tension. Balancing the springs should allow pads to contact the rim simultaneously.

Rim Width Adjustment

The Rim Width Adjuster Screw **F** uses a 2mm hex wrench for adjustment. This feature allows quick setting of the brake to **accommodate** changing out wheels with different rim widths. This feature can also be used for dealing with frame alignment or wheel dish issues. If this feature is used frequently, you may need to reapply blue thread retainer occasionally to the screw threads.

Check

Squeeze the brake lever about 10 times to stretch the cable and seat the housing. Check that the brake is operating correctly and that friction is minimal. Brake pad clearance can be adjusted using the rim width adjust screws **F** on each brake arm.

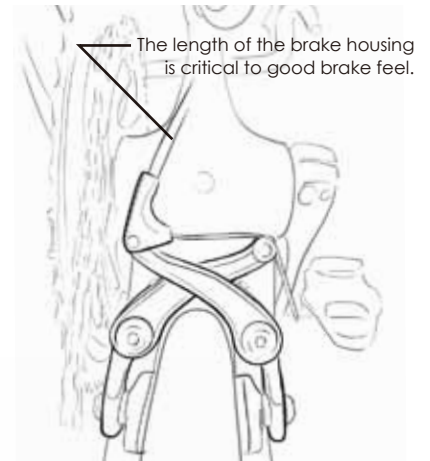

T851 Side pull - Under bottom bracket frame mounting

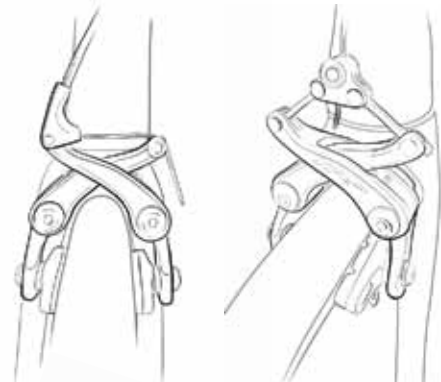

Cable attachment and bending after the clamp bolt.

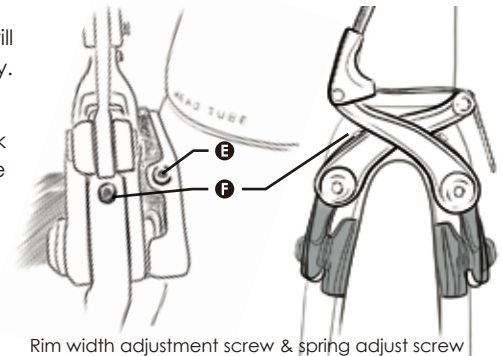

Rim width adjustment screw & spring adjust screw

INSTALLING AND ADJUSTING BRAKE PADS

Changing Brake Pads

Remove the pad retaining screw. Remove the pad by sliding it along the groove of the pad holder.

There are two different types of pads and pad holders to be used in the left and right positions. (Note the orientation of the pads and holders on the bike if removing to replace the pads.) Slide the new pad into the grooves of the pad holder making sure of the direction and fixing bolt hole position relative to the recess in the brake pad.

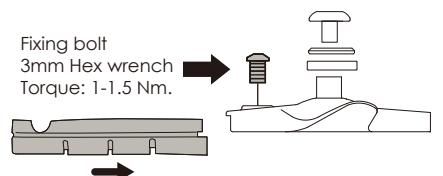

For questions about setup, usage or general inquiries, please contact TRP by e-mail at info@trpbrakes.com or by phone toll free in US, 877-807-4162 or outside US 1-801-648-7079.